

**Fully made of cast iron heavy duty, compact, with special sealing arrangements, suction valve with inspection opening, with wear plate, complete with a TEFV VALCO electric motor.
Self Priming Pumps: Pumps always ready for use!**

Applications:

General purpose electric pumps for clean and polluted liquids and sewage, ideal for sumps, vacuum extraction, pump out duty, flood water, for dirty water with solids, grit and sand and for many other applications.



I-36063 Marostica (Vicenza) Italy
www.valco.eu

VALCO-LEM™ Range VALCO BRAND SELF PRIMING SINGLE STAGE, CONTRACTORS' CLOSECOUPLED CENTRIFUGAL SEMI-TRASH ELECTRIC PUMPS

Pump and motor construction data
with limits of use and operating conditions

TYPES		DIMENSIONS IN mm									DIM. WITH BASE IN mm				Kg	DNa	DNm	D. of solids in susp.	Wear ring material
		L	W	H	a	b	c	d	e	H1	1Ph/3Ph	L	d	e					
VL1H-1	VL1H-1T	372	190	283	229	103	154	110	152	220/196	-	-	-	-	20	1"1/2	1"1/2	11	Stainless st.
VL2-2	VL2-2T	380	185	294	228	120	175	132	172	235/210	-	-	-	-	22	2"	2"	15	Stainless st.
VL2-3	VL2-3T	410	185	294	228	120	175	132	172	257/220	-	-	-	-	24	2"	2"	19	Stainless st.
VL3-4	VL3-4T	485	190	295	228	148	210	132	170	265/227	-	-	-	-	31,5	3"	3"	27	Stainless st.
-	VL2-5T	450	230	316	241	122	203	140	202	237	-	-	-	-	37	2"	2"	8	Stainless st.
-	VL3-6T	-	285	450	365	196	-	-	-	-	700	335	360	650	82,5	3"	3"	8	Cast iron
-	VL3-7T	-	280	450	362	182	-	-	-	-	700	335	360	650	79	3"	3"	19	Stainless st.
-	VL4-8T	-	315	455	335	195	-	-	-	-	700	335	360	650	83,5	4"	4"	37	Stainless st.
-	VL3-9T	-	302	467	385	196	-	-	-	-	790	335	360	750	99	3"	3"	10	Cast iron
-	VL3-10T	-	280	470	383	182	-	-	-	-	790	335	360	750	96	3"	3"	24	Stainless st.
-	VL3-11T	-	302	467	385	196	-	-	-	-	790	335	360	750	105	3"	3"	13	Cast iron
-	VL3-12T	-	280	470	383	182	-	-	-	-	790	335	360	750	98,5	3"	3"	24	Stainless st.
-	VL3-13T	-	302	467	385	196	-	-	-	-	790	335	360	750	112	3"	3"	14	Cast iron
-	VL3-14T	-	350	505	423	196	-	-	-	-	1000	435	470	950	202	3"	3"	16	Cast iron
-	VL4-15T	-	363	544	417	196	-	-	-	-	1000	435	470	950	217	4"	4"	35	Stainless st.
-	VL3-16T	-	355	525	445	185	-	-	-	-	1000	435	470	950	222	3"	3"	13	Cast iron
-	VL4-17T	-	363	544	417	196	-	-	-	-	1000	435	470	950	228	4"	4"	39	Stainless st.
-	VL3-18T	-	355	525	445	185	-	-	-	-	1000	435	470	950	247	3"	3"	14	Cast iron
-	VL3-19T	-	360	530	450	185	-	-	-	-	1000	435	470	950	275	3"	3"	19	Cast iron

Not in scale

PUMPS

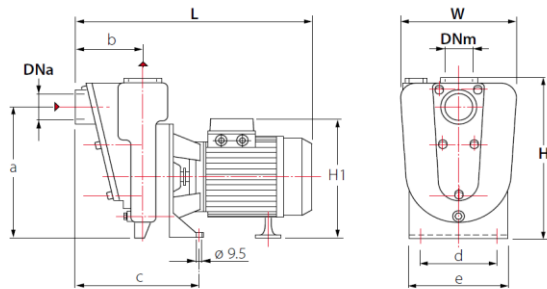

PUMPS WITH BASE

